

27" OUTER
26.25" INNER

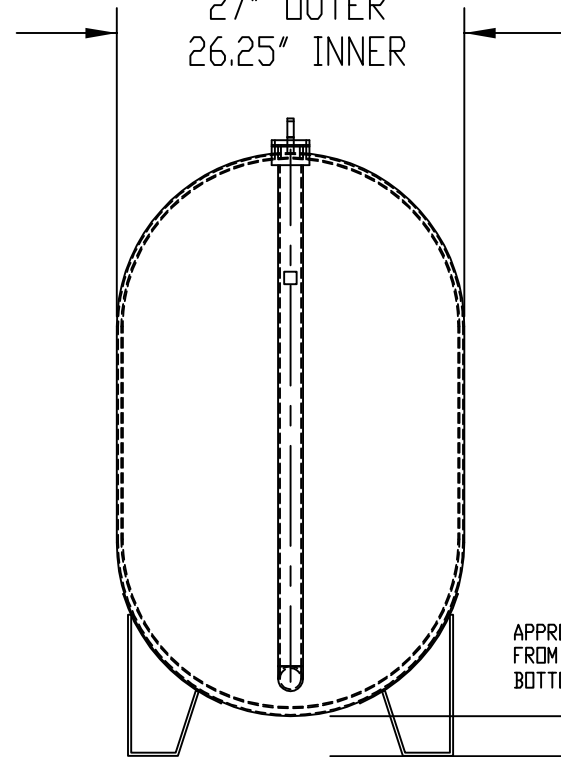
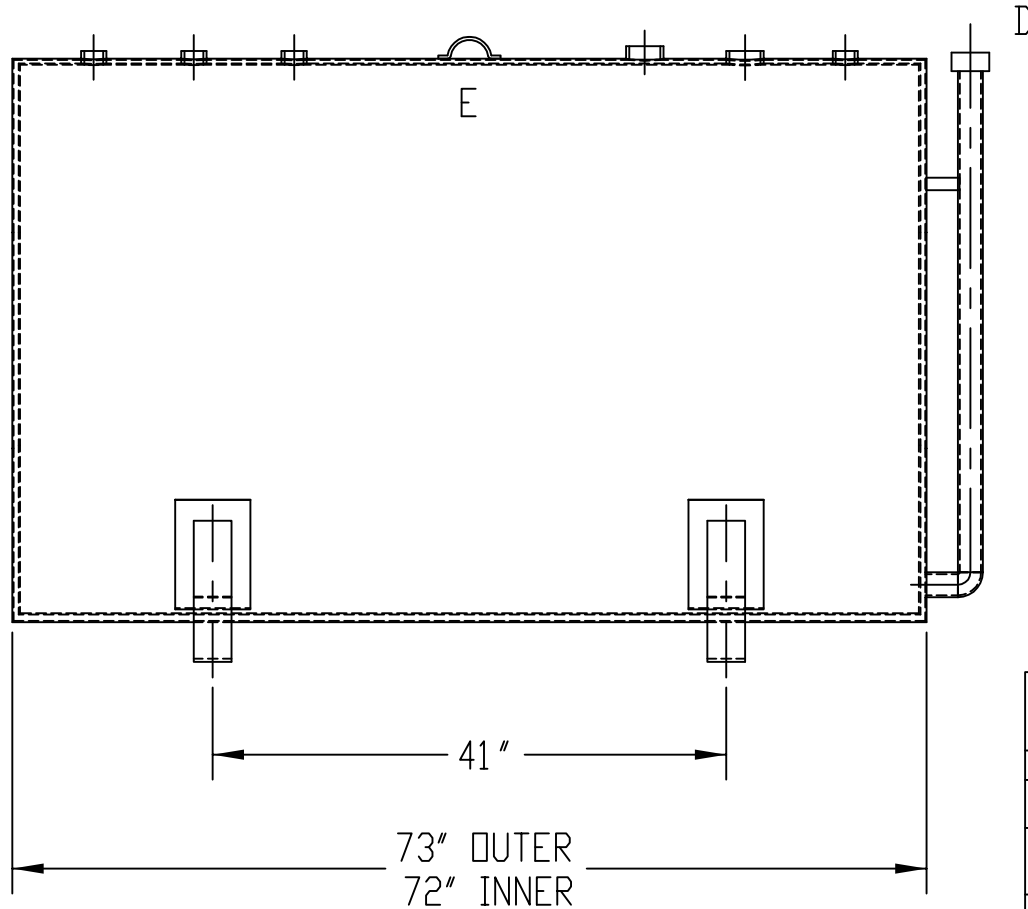

APPROX. 3 3/4"
FROM GROUND TO
BOTTOM OF TANK

DESCRIPTION:	ABOVE GROUND, DOUBLE WALL, STEEL STORAGE TANK 330 GALLONS	REF. TO:	
MATERIAL:	12 GA. INNER/12 GA. OUTER	DATE:	
CONSTRUCTION:	WELDED USING UL-142 STANDARDS	TITLE:	STDW-330-12P
OPENINGS:	4-2" CPL 1-3" INNER E.VENT CPL 1-3" OUTER E.VENT FLANGE	SIZE	
FINISH:	SURFACE PREP: SPCC SP-3 ONE SPRAY COAT OF RED PRIMER	A	A - 2" CPL B - 3" INNER E.VENT CPL C - 3" OUTER E.VENT FLANGE
TURNER TANKS: GOLDSBORO, NC (919) 734 - 8328		SCALE: 1:16	APPROVAL:
			D - 2" INSPECTION PIPE E - FORGED LIFT LUG