

\*Typical 1/8" thick pod, fully sealed weld between tank and saddle.

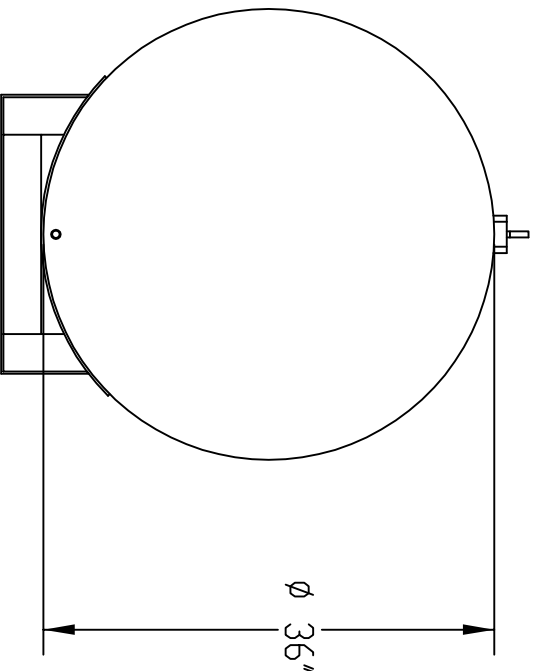

REF. TO: STANDARD TANK  
DATE: 05/20/08

DWG BY: AH

TITLE:

**AS-270-12P**

SCALE: 1:24

LEGEND: ID - (QTY. OF OPENINGS) PART

- A - (4) 2" FNPT FLANGE
- B - (1) 3" EVENT FLANGE
- C - (1) 3/4" FNPT FLANGE
- D - (1) LIFTING LUG

DESCRIPTION:

ABOVE GROUND, SINGLE WALL  
12 GA. STEEL STORAGE TANK  
CAPACITY: 273 GALLONS

FINISH:

SURFACE PREP: SPCC SP-3; ONE  
SPRAY COAT OF PRIMER; OPT FINISH  
APPROX. WEIGHT: 340 lbs ± 5%

SIGNED APPROVAL:



Underwriters  
Laboratories Inc.  
LISTED



1500 HWY 117 S.  
GOLDSBORO, NC 27530  
P: (919) 734-8828  
F: (919) 736-4650